



SB Specialty Metals LLC

Your **First Choice** for Specialty Metals

Rods with two Helical Coolant Holes (30 degrees)

SBC-10.6 and SBC-10.7

ØD (mm)	Length (L) (Tol. 0,+5)	Ød	Bolt Circle TKØ	Pitch (±0.5°)		Deviation (a)
				P	Tol.	
14	330	1.75	7.10	76.18	-1.51,+1.56	0.40
14	330	1.90	6.70	76.18	-1.51,+1.56	0.40
15	330	1.75	7.70	81.62	-1.62,+1.67	0.40
16	330	1.75	8.30	87.06	-1.73,+1.78	0.40
16	330	2.10	8.00	87.07	-1.73,+1.78	0.45
16	330	2.50	8.80	87.06	-1.73,+1.78	0.45
17	330	1.75	8.90	92.50	-1.84,+1.89	0.45
18	330	2.00	9.55	97.95	-1.94,+2.00	0.50
18	330	2.80	9.90	97.95	-1.95,+2.00	0.50
19	330	2.00	10.10	103.39	-2.05,+2.12	0.50
20	330	2.00	10.40	108.83	-2.16,+2.23	0.50
20	330	2.50	10.00	108.83	-2.16,+2.23	0.50
21	330	2.00	11.15	114.27	-2.27,+2.34	0.50
22	330	2.00	11.60	119.71	-2.38,+2.45	0.50
23	330	2.00	12.20	125.15	-2.48,+2.56	0.50
24	330	2.00	12.80	130.59	-2.59,+2.67	0.50
25	330	2.00	13.30	136.03	-2.70,+2.78	0.50

Product Standards

Unground ØD (mm)		Ground ØD (mm)		Ød (mm)		TKØ (mm)	
Range	Tol.	Range	Tol.	range	Tol.	Range	Tol.
6 to ≤24	+0.70,+1.10	3 to ≤25	h5/h6	0.40 to ≤ 0.90	±0.10	TKØ ≤ 4.00	+0,-0.40
25	+0.08,+1.20			0.90 to ≤ 1.70	±0.15	4.01 to ≤ 5.00	+0,-0.60
				ØD=1.75	±0.20	5.01 to ≤ 10.10	+0,-0.80
				ØD=2.00	±0.25	10.01 to ≤ 13.30	+0,-1.00

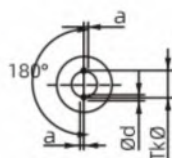
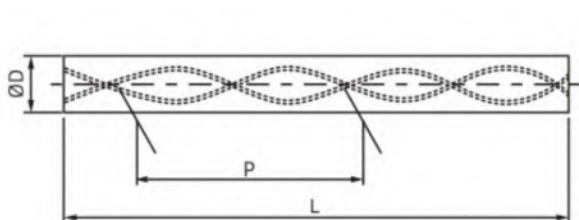

Rods with three Helical Coolant Holes (30 degrees)

SBC-10.6 and SBC-10.7								
ØD	Length (L) (Tol. - 0,+5)	Ød	Bolt Circle TKØ	(±0.5°) Pitch			Hole Deviation	
				P	Tol.		a	α
6	330	0.70	2.75	32.65	-0.65	+0.67	0.15	±4°
6	330	0.50	2.90	32.65	-0.65	+0.67	0.15	±4°
8	330	1.00	4.00	43.53	-0.86	+0.89	0.15	±4°
8	330	0.70	4.00	43.53	-0.86	+0.89	0.15	±4°
10	330	1.40	5.00	54.41	-1.08	+1.11	0.20	±4°
10	330	0.85	5.10	54.41	-1.08	+1.11	0.20	±4°
12	330	1.40	6.00	65.30	-1.30	+1.34	0.30	±4°
12	330	1.10	6.30	65.30	-1.30	+1.34	0.30	±4°
14	330	1.75	7.00	76.18	-1.51	+1.56	0.40	±4°
14	330	1.40	7.30	76.18	-1.51	+1.56	0.40	±4°
16	330	1.75	8.00	87.06	-1.73	+1.78	0.40	±4°
16	330	1.60	8.30	87.06	-1.73	+1.78	0.40	±4°
18	330	2.00	9.55	97.95	-1.94	+2.00	0.50	±4°
18	330	1.70	9.50	97.95	-1.94	+2.00	0.50	±4°
20	330	2.00	10.00	108.83	-2.16	+2.23	0.50	±4°
20	330	1.90	10.20	108.83	-2.16	+2.23	0.50	±4°

Product Standards

Unground ØD (mm)		Ground ØD (mm)		Ød		TKØ (mm)	
Range	Tol.	Range	Tol.	Range	Tol.	Range	Tol.
ØD=6	+0.60,+1.00	6.01 to ≤ 20	h5/h6	0.40 to ≤ 0.90	±0.10	TKØ≤4.00	+0,-0.40
6.01 to ≤ 20	+0.70,+1.10			0.91 to ≤ 1.70	±0.15	4.01 to ≤ 6.00	+0, -0.60
				Ød = 1.75	±0.20	6.01 to ≤ 9.55	+0, -0.80
				Ød = 2.00	±0.25	TKØ = 10.00	+0,-1.00

